

# AIChE Baton Rouge Spring / 2017 Seminar

**Tank University: Tank Venting Fundamentals, API 2000 Overview, Normal & Emergency Venting Devices, Forward & Back-Pressure Regulators, Tank Blanketing Systems, Overfill Protection & API 2350 Guidelines, Safeguarding of Low Pressure Storage Tanks, and Presentation of Design Alternatives**  
**Engineering Ethics Overview**

Friday, May 19, 2017  
8:00AM – 4:30PM

Location: **Oak Lodge** Reception & Conference Center (new)  
2834 S. Sherwood Forest Blvd. Suite E-1 Baton Rouge, Louisiana 70816, (225) 291-6257

**Earn 8 PDH's! Enrollment is Limited! Sign-Up Early!**

## **REGISTRATION FORM**

**NEW!** Register online at [www.aiche-br.org](http://www.aiche-br.org) and pay by credit card using PayPal, or mail this completed form with payment to the address below.

**NAME:** \_\_\_\_\_

**MAILING ADDRESS:** \_\_\_\_\_

**CITY:** \_\_\_\_\_ **STATE:** \_\_\_\_\_ **ZIP:** \_\_\_\_\_

**COMPANY:** \_\_\_\_\_

**EMAIL:** \_\_\_\_\_ **PHONE:** \_\_\_\_\_

**TECHNICAL/PROFESSIONAL SOCIETY MEMBERSHIP\*:** (must indicate) \_\_\_\_\_

**COST:**  
(Please check appropriate box)  \$85/person for Tech/Prof Society Members\* prior to 14-May-17  
 \$95/person for non-Tech/Prof Society Members prior to 14-May-17  
 \$110/person for all after 14-May-17

**MAIL COMPLETED REGISTRATION FORM TO:** Jimmy Orr (Treasurer)  
(Please include check if that is your payment option) 1729 Roseneath Dr.  
Check or cash only, no credit cards on event day Baton Rouge, LA 70806  
Walk-ins welcome space permitting. Email: [jimmy.orr@jacobs.com](mailto:jimmy.orr@jacobs.com)  
Phone: (225) 540-5154

\*The AIChE supports membership in Professional and Technical Societies (see list below)

**Refund Policy:** Advance registration is 100% refundable with notice at least 12 days prior to the date of the seminar. Notice received between 09-May-2017 and 18-May-2017 is 50% refundable. No refunds on day of the seminar.  
**Cancellation:** AIChE reserves the right to cancel this seminar if low attendance is projected. A full refund will be sent in this event.

**EVENT: Tank University Seminar (7 PDHs); Engineering Ethics (1 PDH)**

**DATE: May 19th, 2017**

**PROPOSED AGENDA:**

**7:30 A - 8:00 A Breakfast**

**8:00 A - 11:30 P**

**11:30 P -12:00 P Lunch (provided by AIChE)**

**12:00 P - 4:30 P**

### **TANK UNIVERSITY**

#### **Presenters:**

Ken Ludvigsen – Emerson, Regional Manager (Regulator Technologies)

Daniel Baldwin – Emerson, South Regional Sales Manager (Emerson Rosemount Tank Gauging Systems)

Michael Calaway– Emerson Enardo, Business Development Manager (Regulators/Low Pressure Tank Venting Devices & Systems)

#### **Representatives:**

Rob Mistretta – JHC, Business Manager (Regulators/Low Pressure Tank Venting Devices & Systems)

Joey Breaux – JHC, Director of Tank & Terminals (Overfill Protection Specialist)

**The presentation will cover the fundamentals and latest design alternatives for tank venting, API 2000 overview, normal & emergency venting, forward and back-pressure regulators, tank blanketing systems, overfill protection and API 2350 guidelines, safeguarding of low pressure storage tanks, and presentation of design alternatives. An overview of the presentation includes the following topics:**

- **Tank Venting Standard (API 2000)**
- **Relief & Emergency Vent Valves- Discussion of Normal and Emergency Venting systems and devices; Proper Venting Design per latest API 2000 Standard.**
- **Regulators & Tank Blanketing- The various design options for tank blanketing systems will be covered –Supply-Backpressure Regulators; Low Pressure Gas Blanketing Regulators.**
- **Tank Level Measurement-The latest level measuring devices including transmitters and the latest available technologies.**
- **Overfill Protection Guidelines (API 2350)-Overfill Protection and the latest methodologies and industry trends to be discussed.**

- **Flame Protection & Arrestors-Detonation & Deflagrations; Flame Front Theory & Fundamentals.**

About the presenters:

Ken Ludvigsen – Regional Manager for the past 13 years who has worked with our Local Business Partners to provide product support, training, and application solutions. Ken is a certified Emerson instructor leading schools and conferences at the corporate headquarters in McKinney, TX. He has presented various topics concerning pressure regulator and relief valve function, application, and troubleshooting at ASGMT, AGMSC, ANGA, SGA, Emerson Exchange and Tank University.

Daniel Baldwin – South Regional Sales Manager responsible for Rosemount Tank Gauging products. Daniel started with the company in 1997. In his 20 years with the company, Daniel has held multiple positions, Senior Service Technician, which included the installation, commissioning, and repaired of the Saab/Rosemount Tank Gauging equipment. Direct Sales covering the greater Houston area and now the South Regional Manager for the Tank Gauging business unit of Rosemount.

Michael Calaway – Director of Marketing responsible for the Emerson Enardo Product Line. Michael joined Emerson 3 years ago as a Business Development Manager focused on pressure control applications for refineries and chemical plants. Prior to joining Emerson Michael spent 8 years in the refining industry holding multiple positions including Instrument Engineer, Maintenance Supervisor, and Process Supervisor.

## **Engineering Ethics Overview**

Richard Savoie, P.E. (LAPELS Deputy Executive Director)

**LAPELS Board and Staff**  
**Enforcement & Compliance**  
**Ethical Issues**  
**Quiz**  
**Supervising Professionals**  
**Common Questions**

About the presenter:

Richard Savoie – Deputy Executive Director for the Louisiana Professional Engineers and Land Surveyor's Board (LAPELS). He has served in the position since April 2015. He also served one term as a Board Member from 2007 to 2013.

**Note: Some topics may change without prior notice.**

**Notice: Full day registration only. Registration fees will not be reduced for half day attendance. Attendance signatures will be required at the beginning of each presentation. PDH (Professional Development Hour) certificates will be issued based upon attendance list signatures, with Hours reflecting actual attendance. Fees will not be reduced or partially refunded for partial attendance.**

**\*\*\*Morning and Afternoon Sessions each to include two or three 10 min. breaks (not shown) \*\*\***

**(Map to Oak Lodge (2834 S.Sherwood Forest Blvd. Baton Rouge, LA 70816)**

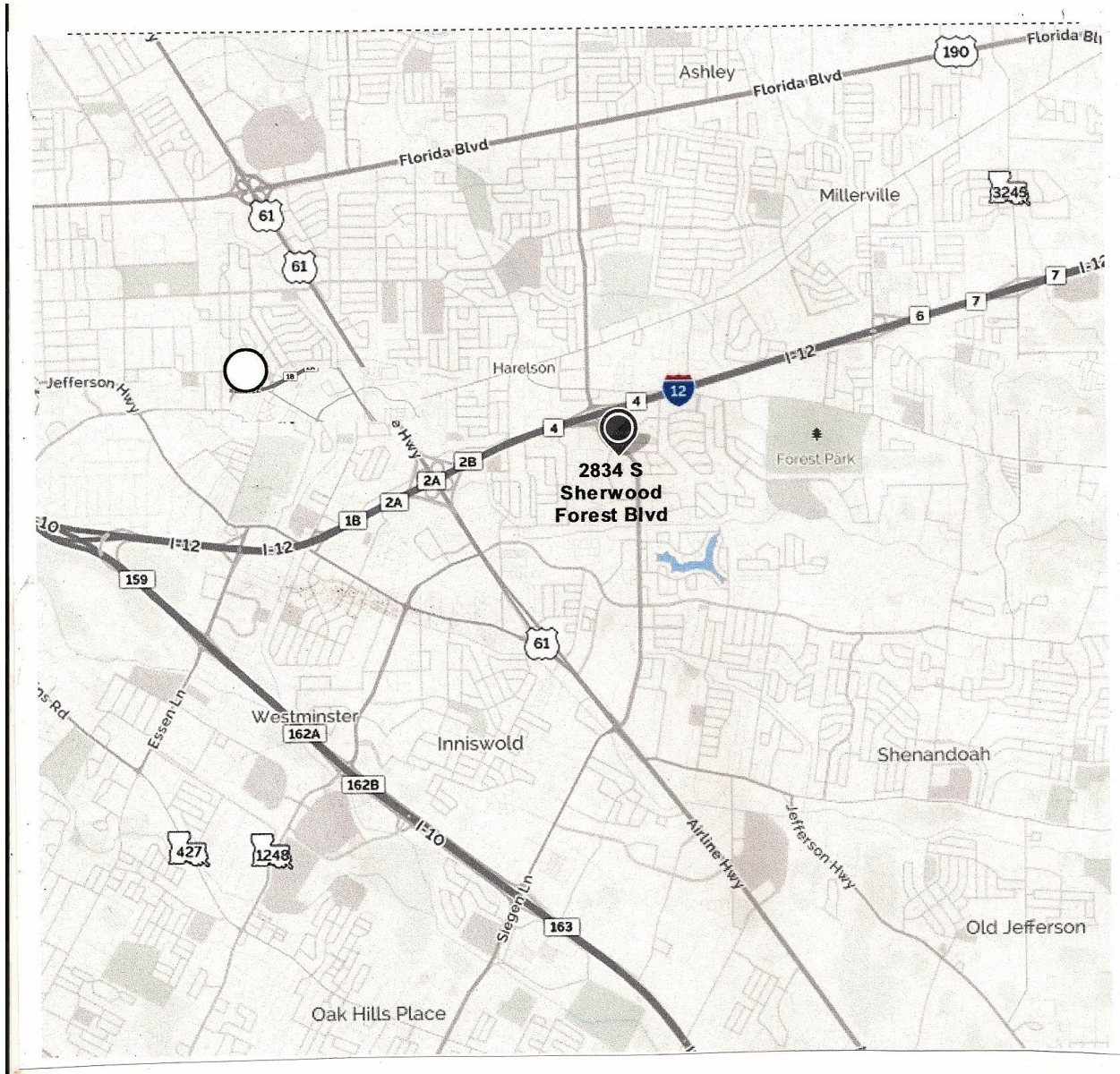

“Oak Lodge” is a little bit hard to find

**Please Reference the next Map to Find “Oak Lodge” in the Local Area**



**Local Area Map**

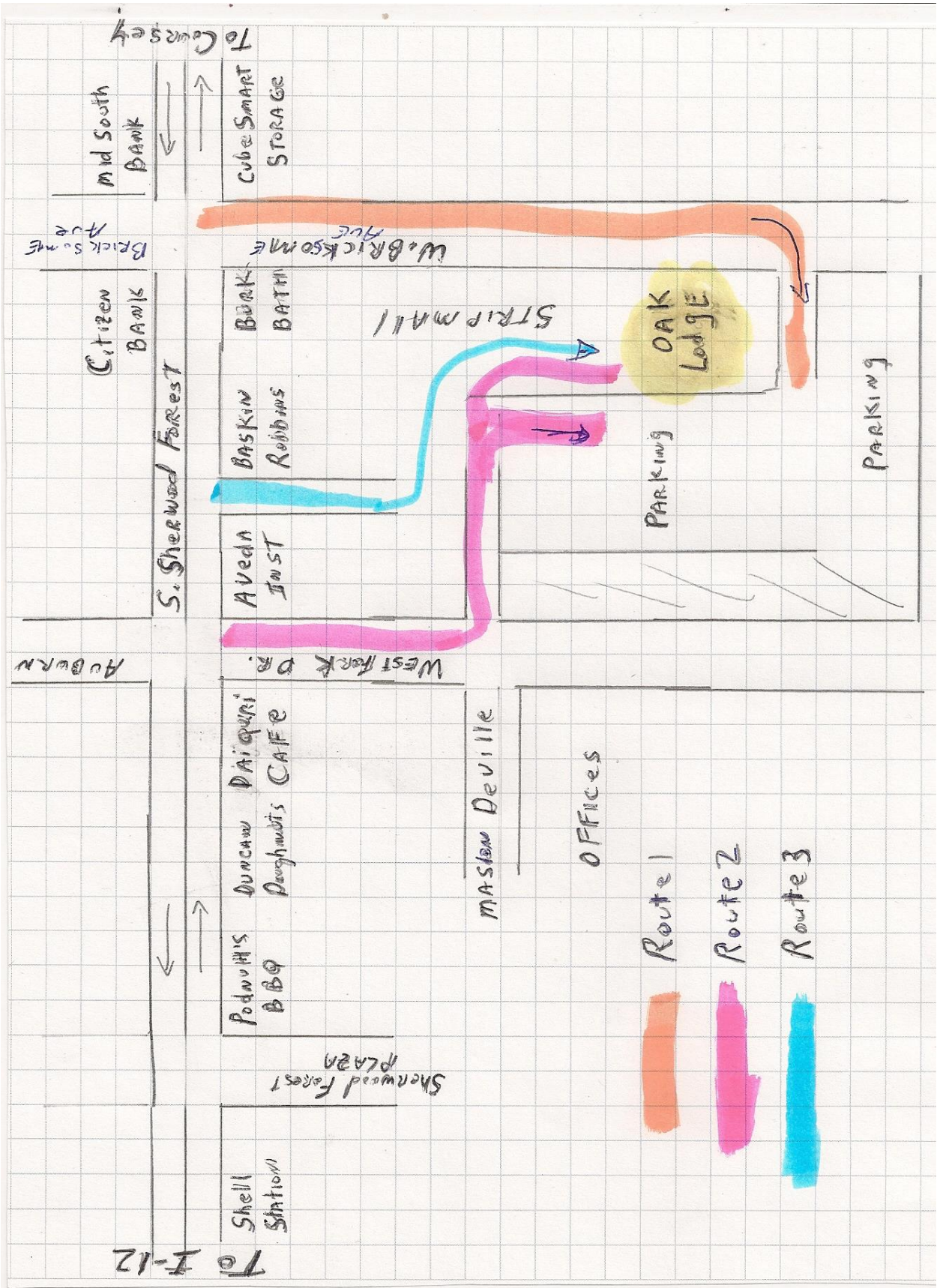

To I-12

To Coursey

Mid South Bank

Citizen Bank

S. Sherwood Forest

Auburn

Shell Station

Podiums BBQ

Duncaw Daiquiri

Doughnut's Cafe

Avedn Inst

Baskin Robbins

Bark Bath

Route 1

Route 2

Route 3

OFFICES

Mason Deville

Sherwood Forest Plaza

CubeSmart Storage

Bricksonme Ave

W. Bricksonme Ave

STRIP MALL

PARKING

OAK Lodge

PARKING

## Local Professional Societies

---

- Louisiana Engineering Society (LES)
- Louisiana Society of Professional Surveyors (LSPS)

## National Technical Societies

---

- America Academy of Environmental Engineers (AAEE)
- American Institute of Architects (AIA)
- American Institute of Chemical Engineers (AIChE)
- American Institute of Electrical Engineers (AIEE)
- American Consulting Engineers Council (ACEC)
- American Concrete Institute (ACI)
- American Institute of Steel Construction (AISC)
- American Management Association
- American Iron and Steel Institute
- American Society of Mechanical Engineers (ASME)
- American Plywood Association (APA)
- American Society of Civil Engineers (ASCE)
- American Society of Engineering Education (ASEE)
- American Society of Heating, Refrigerating, and Air-Conditioning Engineers (ASHRAE)
- American Society of Safety Engineers (ASSE)
- American Wood Council (AWC)
- Earthquake Engineering Research Institute (EERI)
- Institute of Transportation Engineers
- Institute of Electrical and Electronics Engineers (IEEE)
- Instrumentation Systems and Automation Society (ISA)
- National Council of Examiners for Engineering and Surveying
- National Design Specification (NDS)
- National Society of Architectural Engineers
- National Society of Professional Engineers (NSPE)
- Society of Petroleum Engineers (SPE)
- Society of Petroleum Evaluation Engineers (SPEE)
- Society of Professional Well Log Analysts (SPWLA)
- Society of Women Engineers (SWE)
- Air & Waste Management Association (AWMA)